



ROTOSAFE

TECHNOLOGY · INNOVATION · QUALITY · VALUE

Rotary Paddle Level Indicator

Approved for dust-explosive environments
Zones 20, 21 & 22

APPLICATION

The ROTOSAFE rotary paddle switch is designed to signal the presence or absence of bulk materials such as chemical products, wood chips, grain, granules and powders. It is ideal for bunkers, hoppers and silos as well as for blockage detectors in conveyor chutes.

METHOD OF OPERATION

The detection of material is achieved by a rotating paddle. If material impedes the rotation of the paddle, the motor topples on its axle and triggers a contact. The power supply to the motor is cut and the contact signals that the critical level has been reached. When the level of the material goes down again, the motor returns to its initial position and restarts.

The ROTOSAFE has a « Failsafe » rotation detection circuit; it has a magnetic test allowing to shut the motor down.

PADDLE SELECTION

Four alternative paddles are available to detect a wide range of product from heavy to light densities.

OPTIONS

KITRTS – system allowing to have an adjustable level between 0,65 and 2,1 meters.

Detailed specification, wiring diagrams and installation/operating instructions available immediately upon request.



RTS1V0A



ATEX-approved

Ex II 1D T100°C-IP 65-ZONE 20



CLASS 2 div. 1
groups E,F,G



RTOSAFE

TECHNOLOGY · INNOVATION · QUALITY · VALUE

SPECIFICATION

Type	RTS1V0A
Supply	24 V dc, 110/230 V ac 50/60 Hz
Consumption	1,8 VA
Ambiant temperature	-20° to + 50°C
Protection	IP 65
Enclosure	Flame retardant, glass fibre, reinforced nylon
Mounting	1¼ NPT
Conduit entry	2 conduit entries M20
Motor	1 RPM
Fuse	5 Amps
Cable length	min, 1 mm ² - max, 4 mm ²
Sensitivity	2 ranges selected via internal spring position
Switch High/Low	Desired security position (high or low level)
Standard lengths	up to 3,5 m
Output	S.P.C.O contacts, rated at 3A 250V non inductive
Output delay time	User selectable, 0-120 sec (to avoid wrong signals, e.g. in the case of dirt build-up)
Approvals	ATEX EX II 1D T100°C
Indication	1 LED for the supply - and 1 LED for the output state
Weight	0,95 Kg

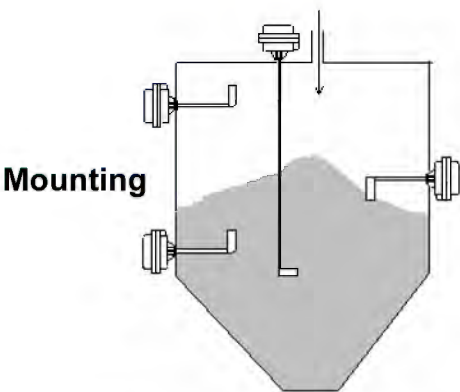

Connections

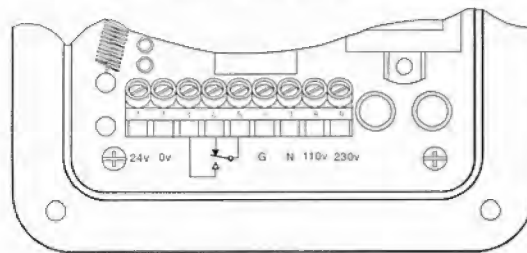

KIT RTS

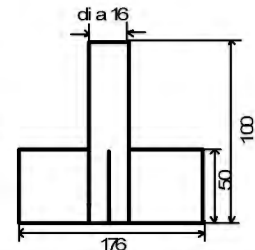
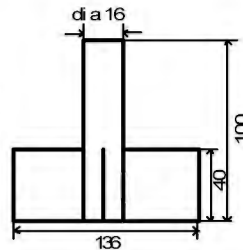
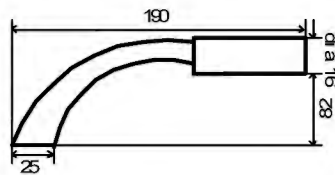
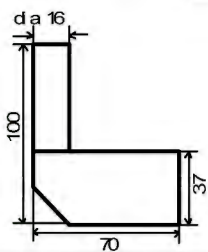

RLIP1	RLIP2	RLIP3	RLIP4
Single vane paddle	Single vane insertable paddle for materials	3 vane paddle for materials	Large 3-vane paddle for materials less than 480 kg/m ²
Density higher than 1120 kg/m ²	480 to 1120 kg/m ²	480 to 1120 kg/m ²	

Please refer to instruction manual for correct installation .
Information subject to change or correction. July 2007.